

Cable Guided Insulating Honeycomb Door Shade

Cable guided, motorized shade with wireless radio frequency (RF) control
Installation Guide—Please Read Before Installing

English

1 Prepare to Install

Important Notes

Please Read Before Installing

- ⚠ WARNING: SHOCK HAZARD.** Can cause serious injury or death. Turn off power at the main service panel before connecting or servicing a shade with wired power supply.
 - ⚠ CAUTION: RISK OF FALLING OBJECTS.** Securely install the shade system per the mounting instructions. Failure to do so could result in minor or moderate injury.
- A. Read, follow, and save these instructions.
 - B. When mounting the Top Cable Brackets and Shade Brackets, make sure you are screwing into solid wood if possible. If not, you must use appropriate fasteners (not included) for the mounting surface. Toggle bolts are included for mounting the lower cable anchors on a hollow door.
 - C. Make sure the brackets are aligned with each other. If not, the shade may not properly snap into the brackets.
 - D. Install the shade on its brackets and ensure a clear path for its travel before installing batteries.
 - E. To reduce the possibility of RF interference, keep LTE Devices (routers, mobile phones, etc.) at least 3 ft (1 m) away from shade.

Included Components

- Shade
 - Top cable brackets
 - Shade brackets
 - Mounting screws
 - Spacers, if applicable
 - Guide cables
 - Cable tube
- Grommets
 - Cable end anchors
 - Housing (1 ea)
 - Cable carriage (1 ea)
 - Tension screw (1 ea)
 - Cap (1 ea)
 - Toggle bolt (1 ea)
- Pencil
 - Tape measure
 - #1 Phillips screwdriver
 - #2 Phillips screwdriver
 - Wire cutter
 - Drill
 - 3/32 in (2.4 mm) drill bit
 - 7/16 in (11 mm) drill bit for hollow door, if applicable

2 Install the Top Cable Brackets

2.1 Mark the Mounting Surface

- A. Hold the shade up to the mounting surface, approximating its mounting location to verify it will cover the window as intended.
- B. Center the shade over the window and use a pencil to mark the mounting surface at each end of the shade.

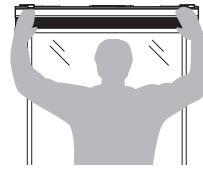

2.2 Attach the Top Cable Brackets to the Mounting Surface Above the Window

- A. The centers of the Top Cable Brackets align 1.5 in (38 mm) from the ends of the shade. Use the marks you made in step 2.1 to measure the distance and locate the Top Cable Brackets on the mounting surface. Mark the hole locations for pre-drilling at least 2.75 in (76 mm) above the window trim.

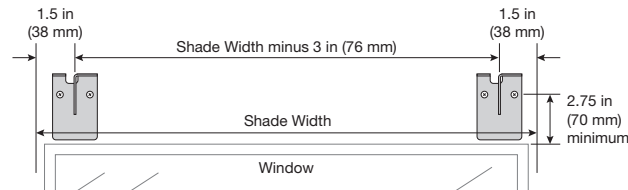

- B. Use a level to make sure the marks are aligned.

- C. Pre-drill holes for the screws.

NOTE: If you are mounting above a window with protruding trim, or installing a shade less than 26 in (660 mm) wide, install a spacer behind each Top Cable Bracket. See profile view at right.

- D. Mount the Top cable brackets using the provided screws or other appropriate fasteners.

Mounting Above Trim

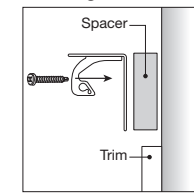

4 Install the Guide Cables

4.1 Locate the Guide Cable passages

The shade is equipped with two (2) Guide Cable passages, one approximately 1.5 in (36 mm) from each end.

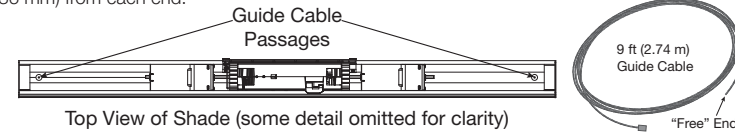

4.2 Feed the Guide Cables Through the Shade

Each 9 ft (2.74 m) Guide Cable includes a cable stop at one end. A tube is included to help feed the cables through the shade. Use it as described below for both cables, then discard.

- A. Position the shade so that one end extends off a table or other work surface. Insert the included cable tube into the underside of the shade and up through the cable passage until it comes out the top. Feed the free end of one cable down into the tube from the top of the shade until it exits the tube below the shade. Remove the tube from below.

- B. Pull the entire length of the Guide Cable through. Repeat on the other end of the shade.

- C. Install a grommet on each cable. Slide it up the cable to the shade and snap it into the hole where the cable exits the bottom of the shade's hem bar.

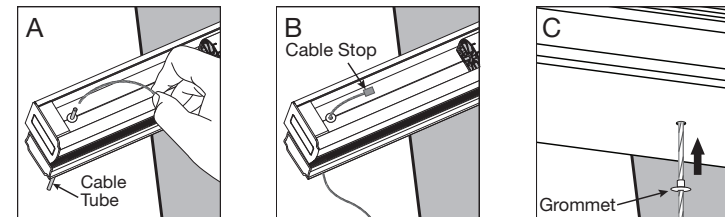

4.3 Suspend the Guide Cables

- A. Position the shade near the window, oriented so that the Guide Cables inserted in step 4.2 are positioned below the corresponding left and right Top Cable Brackets mounted above.

- B. Pull the cable stop end of the right-side cable up and insert the cable stop through the large hole in the Top Cable Bracket.

- C. Seat the cable in the small end of the hole to secure it.

- D. Repeat on the left side in the opposite direction.

NOTE: Insert the right Guide Cable through the Top Cable Bracket from the left as shown above. Insert the left Guide Cable from the right, so the Guide Cables hang inside the Top Cable Brackets as shown below.

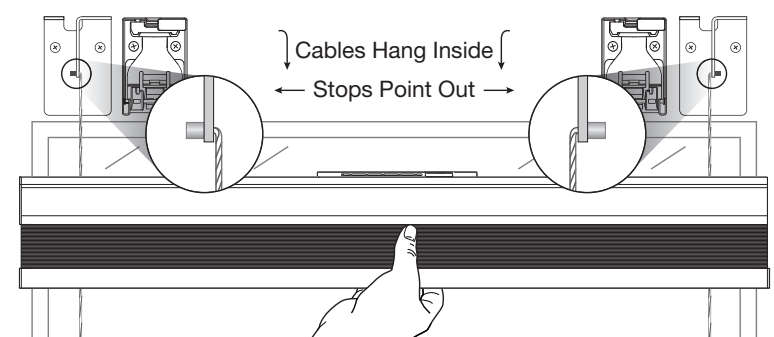
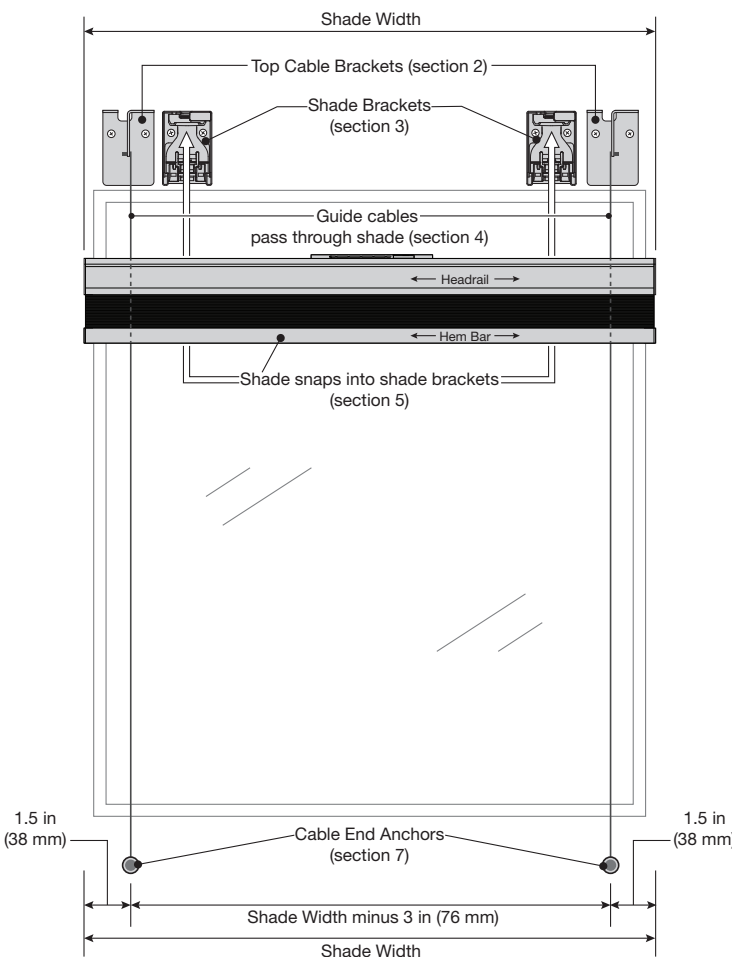

Figure 1. System Overview (typical installation)

Review the following diagram to familiarize yourself with the system components, and the way they are configured in a typical installation. It is important that the installation steps are followed in order.



3 Install the Shade Brackets/Prepare the Shade

3.1 Attach Shade Brackets to the Mounting Surface Above the Window

NOTE: If there are yellow bracket-location labels on the shade headrail, use them as a guide to the correct Shade Bracket locations. Otherwise, use the placements shown in Figure 3.1 at right to prevent brackets from interfering with battery installation or shade operation.

- A. Establish bracket positions on the mounting surface and mark hole locations for pre-drilling.

The tops of the Shade Brackets should be at the same height as the tops of the Top Cable Brackets, as shown. (Typical 2-bracket installation shown. Number of brackets varies with shade width. See Figure 3.1 at right.)

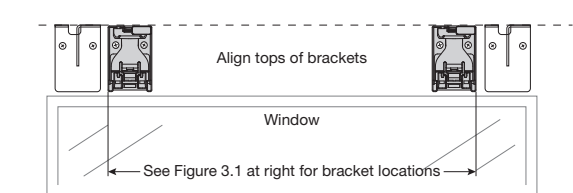

- B. Use a level to make sure the marks are aligned.

- C. Pre-drill holes for the screws. Repeat for all brackets.

NOTE: If you are mounting above a window with protruding trim, or installing a shade less than 26 in (660 mm) wide, install a spacer behind each Shade Bracket.

- D. Mount the Shade Brackets using the provided screws or other appropriate fasteners.

Mounting Above Trim

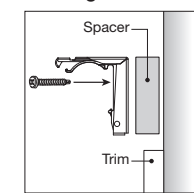

3.2 Position Antenna for Optimum Wireless Communication

NOTE: This step is not necessary for shades without a yellow antenna label on the headrail.

- A. Remove the yellow antenna label from the headrail to free the antenna from its shipping position.

- B. Install the antenna clip in its operating position on the rear lip of the headrail. Press until it locks into place with a "click" at both ends. (The antenna is a wire embedded in the clip.)

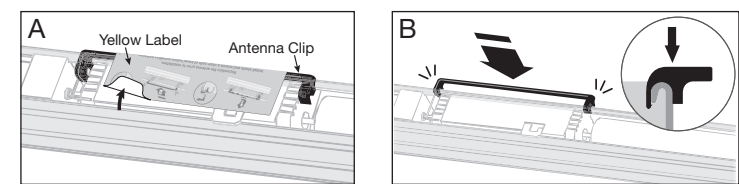
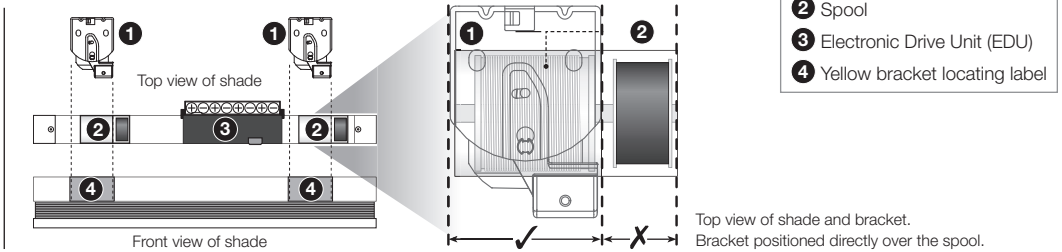

Figure 3.1 Shade Bracket Placement Guide

Shades with (2) spools and (8) AA batteries (2 brackets)

- AA battery holders may be within the headrail or attached to the rear of the headrail (shown).
- Use the yellow bracket locating labels 4 on the headrail as a guide to the correct bracket 1 mounting positions directly above each spool 2.



Shades with (2) spools and (4) D-cell batteries (2 brackets)

- One battery holder at each end of the shade accepts (2) D-cell batteries, (4 batteries total).
- Bracket 1 position is 3 in (76 mm) from each end of the shade, above the outer battery position. This ensures adequate battery installation/change clearance after the shade is installed.

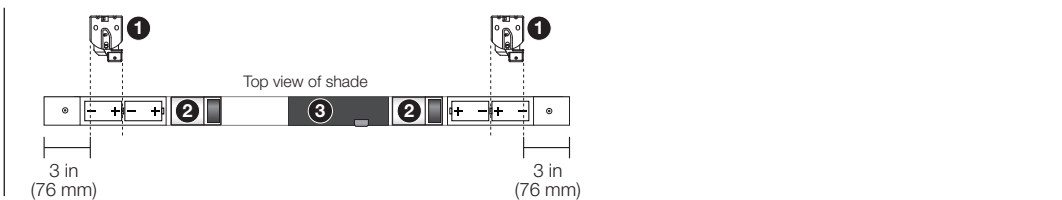

Shades with (3) spools and (6) D-cell batteries (3 brackets)

- One battery holder at each end of the shade accepts (3) D-cell batteries, (6 batteries total).
- Outer bracket 1b position is 3 in (76 mm) from each end of the shade, above the outer battery position. This ensures adequate battery installation/change clearance after the shade is installed.
- Position the center bracket 1a 2 in (51 mm) to the left of the Electronic Drive Unit 3.

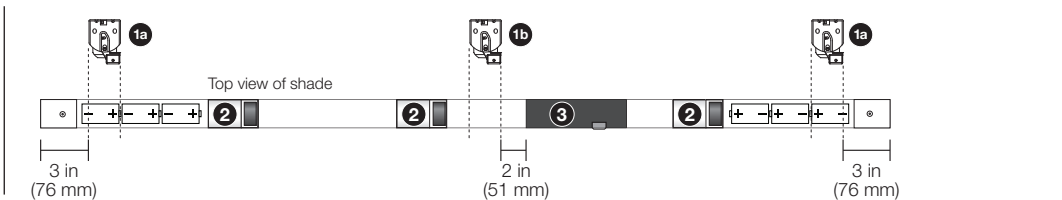

Shades with (4) spools and (8) D-cell batteries (4 brackets)

- One battery holder at each end of the shade accepts (4) D-cell batteries, (8 batteries total).
- Outer bracket 1b position is 3 in (76 mm) from each end of the shade, above the outer battery position. This ensures adequate battery installation/change clearance after the shade is installed.
- Position the inner brackets 1a centered on marks measured at 1/3 the shade width from each end.

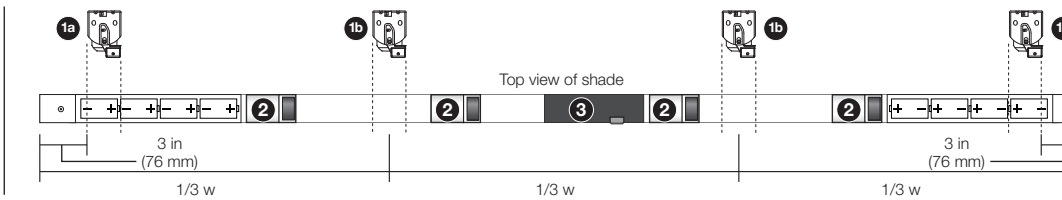

5 Install the Shade

5.1 Mount Shade in Brackets

Holding the shade in both hands, tilt the top of the shade slightly toward the window and hook the front edge into the brackets behind the battery release tabs (➡ **PUSH**). Then rotate the back of the headrail up and press the bottom of the headrail firmly until you hear it click into place. **IMPORTANT:** Be certain no fabric cells are caught in the brackets.

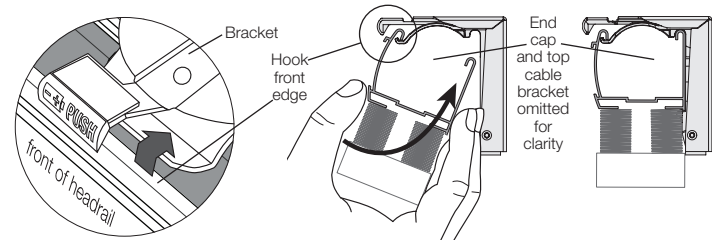

Power Source Options (sold separately)

Batteries (type and quantity vary with shade width):

Eight (8) AA, lithium



Four (4) D, alkaline



Six (6) D, alkaline



Eight (8) D, alkaline

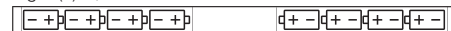

Individual Power Supply:

CSPS-P1-1-6-WH



10 Output Power Supply Panel:

CSPS-P1-10-6



5.2 Install the Power Source

Press ALL battery release tabs (➡ **PUSH**) above the headrail. The shade will tilt forward.

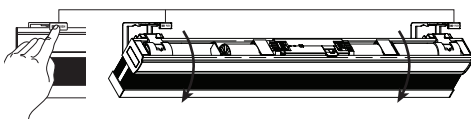

NOTE: Shades are manufactured for battery power or wired power according to the original order. The two types are not interchangeable or convertible.

Battery-powered shades

Install the batteries as indicated in the battery holders (so the +/- signs match). Make sure the batteries are fully inserted into the trays. The Shade Button will blink red/green 3 times when shade is powered.

NOTE: For best battery life, DO NOT mix old and new batteries. Use ONLY alkaline D size batteries or lithium AA size batteries. DO NOT install carbon-zinc or rechargeable batteries, and DO NOT mix battery types.

Wired-power shades

With individual plug-in power supply

Uncoil the cable from inside the headrail and plug it into the individual power supply. Plug the individual power supply into an outlet. The Shade Button will blink red/green 3 times when shade is powered.

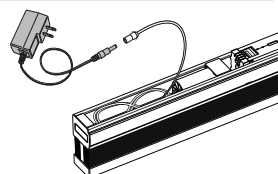

Connected to 10 Output Power Supply Panel

For wiring instructions from a 10 output power supply, refer to the power panel instruction guide (P/N 045-348) that came with the 10 output power supply panel.

5.3 Return the Shade to Operating Position

Tilt the shade back into the brackets; pressing gently until you hear a click.

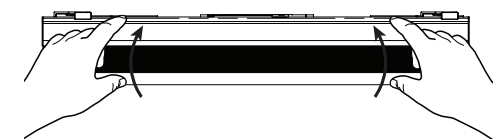

6 Assign Control and Program Shade

Compatible Controls (sold separately):
Pico® wireless control

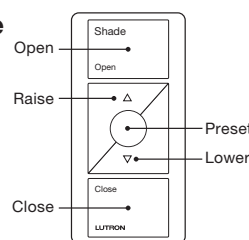

6.1 Assign Controls

A. Press the Shade Button on one of the shades you want to assign. The Shade Button illuminates green while in programming mode.

NOTE: Programming mode will time out after 30 seconds of inactivity.

B. Press and hold the "Close" button on the control for about 6 seconds, until the Shade Button blinks and turns off—exiting programming mode.

C. Repeat steps A and B for each additional shade assigned to the same control

D. Repeat steps A, B, and C for any shades assigned to additional controls.

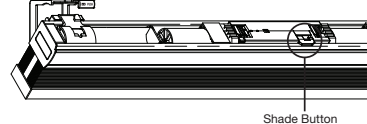

6.2 Adjust Upper Limit (OPTIONAL)

The shade's upper limit is factory programmed based on the window dimensions and mounting option. If adjustment is needed, follow these steps:

A. Press the Shade Button on the shade you want to adjust. The Shade Button illuminates green while in programming mode.

NOTE: Programming mode will time out after 30 seconds of inactivity.

B. Press and hold the "Open" and "Raise" buttons on the control simultaneously for about 5 seconds, until the Shade Button blinks and remains on.

C. Use the control's "Raise" and "Lower" buttons to adjust shade position to the upper limit you prefer.

NOTE: When raising the shades, do not compress the fabric too much. Cells should just be gently closed.

D. Press and hold "Open" button for about 5 seconds, until the shade button blinks and turns off, indicating the upper limit is set.

NOTE: For Pico® wireless controls with an LED, simultaneously press and hold "Open" and "Raise" until the LED on the Pico® turns off—exiting programming mode.

6.3 Adjust Lower Limit (OPTIONAL)

The shade's lower limit is factory programmed based on the window dimensions and mounting option. If adjustment is needed, follow these steps:

A. Press the Shade Button on the shade you want to adjust. The Shade Button illuminates green while in programming mode.

NOTE: Programming mode will time out after 30 seconds of inactivity.

B. Press and hold the "Open" and "Raise" buttons on the control simultaneously for about 5 seconds, until the Shade Button blinks and remains on.

C. Use the control's "Raise" and "Lower" buttons to adjust shade position to the lower limit you prefer.

D. Press and hold "Close" button for about 5 seconds, until the shade button blinks and turns off, indicating the lower limit is set.

NOTE: For Pico® wireless controls with an LED, simultaneously press and hold "Open" and "Raise" until the LED on the Pico® turns off—exiting programming mode.

6.4 Set Preset Levels (OPTIONAL)

The preset level is factory programmed to 50% open/closed.

A. Use the control's "Raise" and "Lower" buttons to adjust shade position to the level you prefer.

B. Press and hold the "Preset" button on the control for about 5 seconds, until the Shade Button blinks and turns off.

6.5 Set Preset on Multiple Shades to Different Levels (OPTIONAL)

A. Repeat step 6.4:A for one shade at a time; disconnecting the power source from all other shades while the preset level is set. To disconnect a shade's power source, remove one battery, (battery models), or, unplug the power supply, (wired models).

B. When all preset levels are set, restore power to all shades and perform step 6.4:B to set the preset levels.

Restoring Factory Default Settings

- This will remove any controls assigned to the shade. It will not affect the shade's upper and lower limits.
- Tap the Shade Button quickly three times, and hold the Shade Button after the third tap until the Shade Button LED blinks GREEN rapidly.
- Immediately tap the Shade Button quickly three more times, until the Shade Button LED blinks GREEN rapidly, then blinks RED/GREEN three times, and turns off.

7 Install the Guide Cable End Anchors

7.1 Attach the End Anchors to the Mounting Surface Below the Window

A. Lower the shade to its lower limit or the desired fully lowered position.

B. Allow the shade and the Guide Cables to hang freely. Mark the mounting surface at the cable locations below the hem bar.

C. Use a level to make sure the marks are aligned. The distance between the marks should equal the total shade width minus 3 in (76 mm).

NOTE: For proper operation, it is important that the Guide Cables are plumb and parallel to each other. Re-check and verify the location of the marks before drilling.

D. Pre-drill holes for the screws.

NOTE: Verify the screws will not reach through the backside of the door. Use shorter screws, (not included), if necessary. When mounting to a hollow door, use the included toggle bolts and pre-drill using a 7/16 in (11 mm) drill bit.

E. Using the provided screws or other appropriate fasteners, mount each Cable End Anchor as shown, with its upper and lower notches positioned to capture the Guide Cable.

NOTE: If you installed spacers behind the Top Cable Brackets, install a spacer (included) behind each End Anchor. Position the spacer's indexing pin at bottom-center. See profile view above.

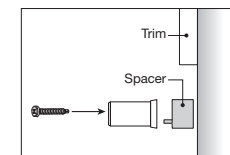
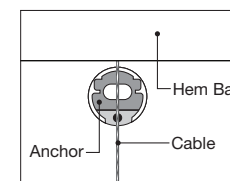

7.2 Attach the Cable Carriages to the Guide Cables

Raise the shade to its upper limit or the desired fully raised position.

A. Loosen (do not remove) the clamp screw in the Cable Carriage, then thread the free end of one Guide Cable through the slot, and then through the holes above and below the clamp screw as shown.

B. Insert the short side of the Cable Carriage into the top slot of the mounted anchor housing. 1. With the Guide Cable positioned to the right of, and behind the head of the clamp screw, pull the cable taut from below while tightening the clamp screw down on the cable.

C. Verify that the cable is firmly secured under the clamp screw head, and did not slip out from under it during tightening. Loosen and re-secure, if necessary.

D. Repeat steps A, B, & C for the other Guide Cable.

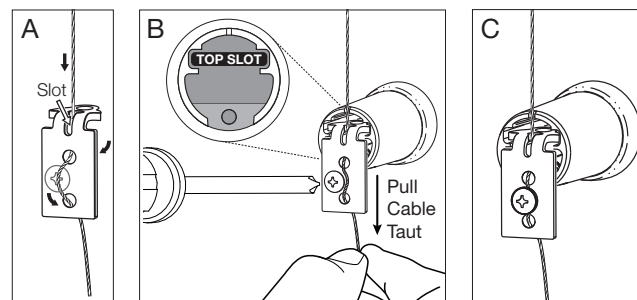

7.3 Insert the Cable Carriages and Tension the Guide Cables

A. Re-orient the Cable Carriage.

1. Remove the Cable Carriage from the anchor housing, turn it around so that the clamp screw faces up.

2. Re-insert the Cable Carriage into the top slot of the anchor housing, ensuring the cable from above lands in the upper notch of the anchor housing as shown.

3. Insert the tension screw through the hole in the Cable Carriage and thread it into the anchor housing.

B. Tension the Guide Cable.

1. Tighten the tension screw to add tension to the Guide Cable.

NOTE: If the Top Cable Bracket and Cable End Anchor are securely mounted, you will be able to fully seat the tension screw.

C. Install the Cable End Anchor cap, making sure to properly align the tabs on the cap with the top slot openings in the anchor housing as shown. Use a wire cutter to trim away the excess cable below the anchor.

D. Repeat steps A, B, & C for the other Guide Cable.

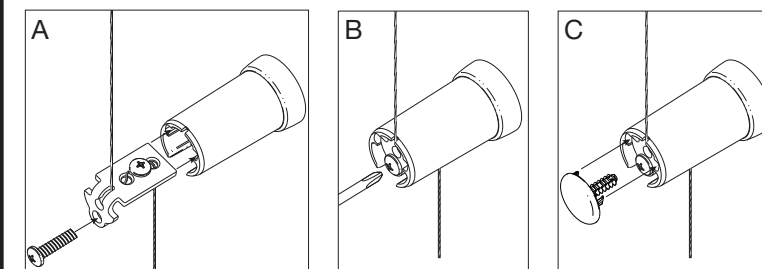

Troubleshooting

A Shade Does Not Respond

IMPORTANT: The shade is designed to respond when a control button is *released*. For best response during normal operation, tap-and-release control buttons. Do not press and hold unless instructed.

A-1 Tap the Shade Button. Does the Shade Button LED light up GREEN?

➔ **NO**, Shade Button LED doesn't light up at all
➔ **Battery powered shade:** 1) Make sure the batteries are installed in the correct orientation. 2) Make sure batteries are fresh, or install new batteries.

➔ **Wired shade:** 1) Make sure the power supply/panel is plugged in to a powered outlet. 2) Make sure the shade power cable is properly connected to the plug-in supply or power panel, and system power is available.

➔ **NO**, Shade Button LED is RED and/or blinking. See "Shade Button Blink Codes"

➔ **YES** Continue to **A-2** below...

A-2 Make sure the control is assigned to the shade by performing the steps in section 6.1: "Assign Controls" of the installation instructions.

Does the Shade Button LED blink GREEN while assigning controls?

➔ **NO**, Shade Button LED does not respond to control input
➔ 1) See section 3.2: "Reposition Antenna Clip..." of the installation instructions.

➔ 2) Restore the shade's factory default settings. See the section: "Restoring Factory Default Settings" at the bottom of Section 6.

➔ **NO**, Shade Button LED is RED and/or blinking. See "Shade Button Blink Codes"

➔ **YES**, Shade Button LED responds correctly, but shade still not moving

➔ 1) Repeat section 6.1: "Assign Controls" of the installation instructions, and be sure to hold the "Close" button until the Shade Button LED blinks.

➔ 2) Reset the upper and lower limits. See sections 6.2: "Adjust Upper Limit" and 6.3: "Adjust Lower Limit" of the installation instructions.

NOTE: If the shade responds while assigning controls or setting upper and lower limits, but fails to respond afterward, wait at least 5 minutes, then retry normal operation.

B Wireless Control Range Is Too Short

➔ **B-1** See section 3.2: "Position Antenna..." of the installation instructions.

C Shade Is Not Level

➔ **C-1** Leave shade in lowered position to allow fabric to relax. Time required to relax may vary (up to 24 hours).

D Shade Does Not Reach Cable Anchors

➔ **D-1** Reset the lower limit. See section 6.3: "Adjust Lower Limit" of the installation instructions.

➔ **D-2** Leave shade in lowered position to allow fabric to relax. Time required to relax may vary (up to 24 hours).

➔ **D-3** Check the anchor mounting locations. Guide Cables must be parallel.

Shade Button Blink Codes

RED/GREEN RED/GREEN RED/GREEN Over a 3-second span indicates normal power-up when batteries are inserted or power connected.

One RED blink every 5 seconds = low batteries. Install new batteries.

Solid RED during shade movement = low batteries. Install new batteries.

For complete warranty information, please visit: lutron.com/TechnicalDocumentLibrary/Window Systems Warranty.pdf

FCC Information

NOTE: This equipment has been tested and found to comply with the limits for a Class B digital device, pursuant to part 15 of the FCC rules. These limits are designed to provide reasonable protection against harmful interference in a residential installation. This equipment generates, uses and can radiate radio frequency energy and, if not installed and used in accordance with the instructions, may cause harmful interference to radio and television reception, which can be determined by turning the equipment off and on. The user is encouraged to try to correct the interference by one or more of the following measures:

- Reorient or relocate the receiving antenna.
- Increase the separation between the equipment and receiver.
- Connect the equipment into an outlet on a circuit different from that to which the receiver is connected.
- Consult the dealer or an experienced radio/TV technician for help.

Caution: Changes or modifications not expressly approved by Lutron Electronics Co. could void the user's authority to operate this equipment.

This device complies with Part 15 of the FCC Rules. Operation is subject to the following two conditions:

- (1) This device may not cause harmful interference, and
- (2) This device must accept any interference received, including interference that may cause undesired operation. This Class B digital apparatus complies with Canadian ICES-003.

IC Information

This device complies with Industry Canada licence-exempt RSS standard(s). Operation is subject to the following two conditions:

- (1) This device may not cause harmful interference, and
- (2) This device must accept any interference received, including interference that may cause undesired operation of the device.

Worldwide Headquarters | USA

Lutron Electronics Co., Inc.
7200 Suter Road
Coopersburg, PA 18036-1299 USA
TEL: 1.610.282.3800
FAX: 1.610.282.3090
Technical Support: 1.800.523.9466
Toll Free: 1.888.LUTRON1
shadinginfo@lutron.com
Lutron.com

Europe Headquarters | United Kingdom

In EEA imported by:
Lutron EA Ltd
125 Finsbury Pavement, 4th floor
London EC2A 1NQ
UK TEL: +44.(0)20.7702.0657
FAX: +44.(0)20.7480.6899
Technical Support: +44.(0)20.7680.4481
FREEPHONE: 0800.282.107

